

Bend-Sofa

SOFAS

2010

Patricia Urquiola

CONTEXT

ENQUIRIES
info@contextgallery.com
Tel. 404. 477. 3301
Tel. 800. 886.0867
contextgallery.com



Description

Bend-Sofa is a modular sofa with a great personality. It seems to have been moulded by an artist's hand, but actually originates from the study of 3D models and digital research. Its irregular shape enhances comfort. The very name Bend-Sofa effectively expresses the idea of movement obtained by the alternation of solids and voids, underlined by the contrasting stitching that gives rise to a further design on its irregular and sinuous surface. The corrugated modules, assembled starting from seat, ottoman and corner elements, develop a large number of configurations, from linear versions in compact dimensions to large compositions, as well as original and alternative solutions that stand outside traditional canons.

Technical information

Internal frame

tubular steel and steel profiles

Internal frame upholstery

Bayfit® flexible cold shaped polyurethane foam, polyester fibre cover

Back cushion (B40C-B55C)

down feather and polyurethane insert, box style typology, zig zag stitching

Support (BS-BSB)

visco-elastic polyurethane, polyester and cotton fibre cover

Feet

thermoplastic material

Cover

fabric or leather (zig zag stitching)

CONTEXT

ENQUIRIES
info@contextgallery.com

Tel. 404. 477. 3301
Tel. 800. 886.0867

Technical drawings

B164C

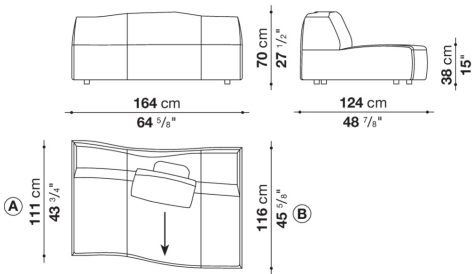

B214C

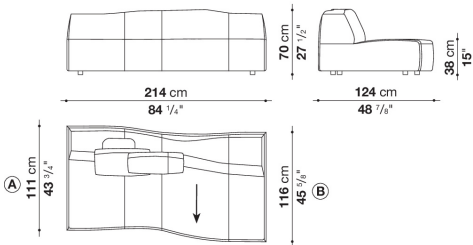

B214CS

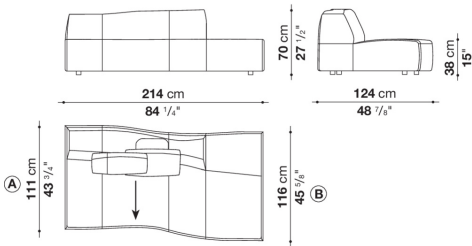

B214CD

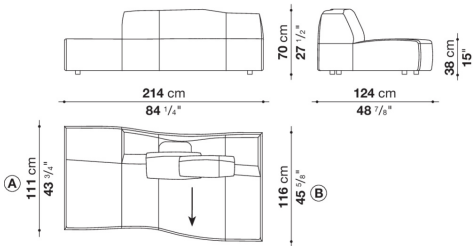

B214TS

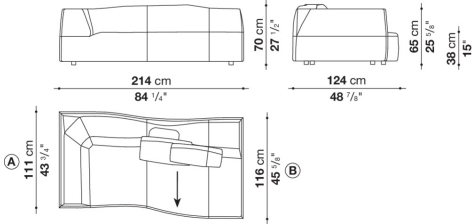

B214TD

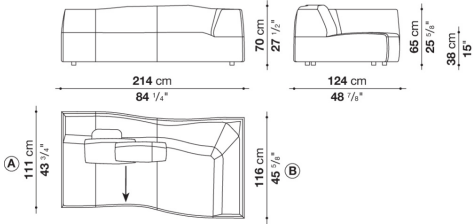

CONTEXT

B111A

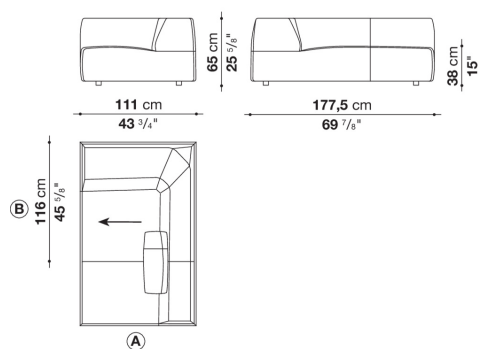

B116A

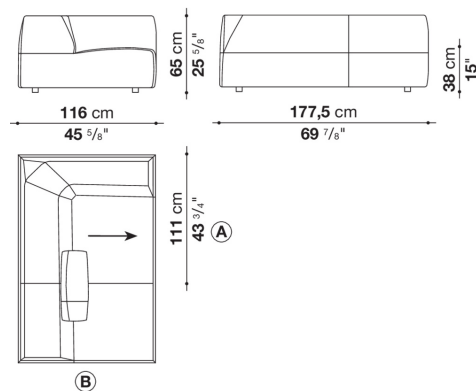

B177LS

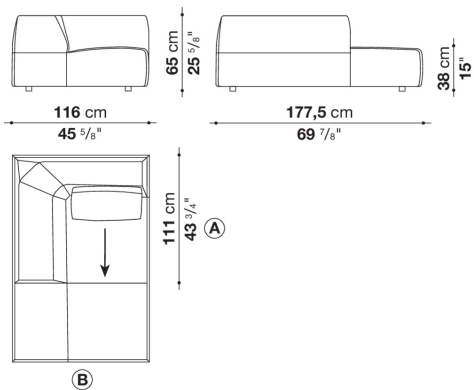

B177LD

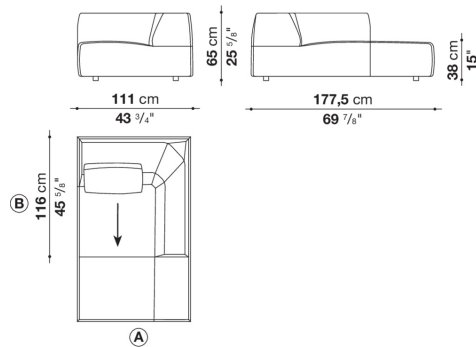

B111P

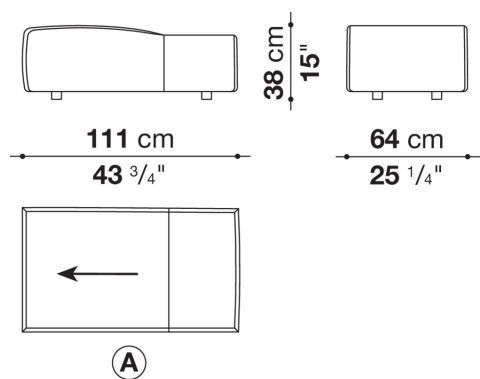

B116P

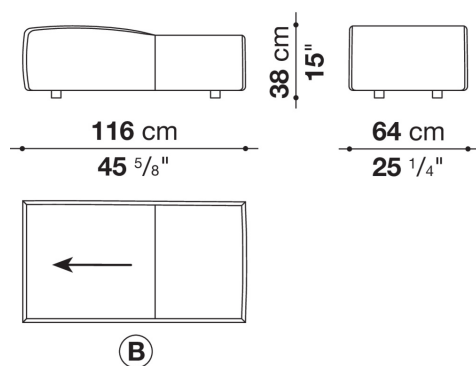

CONTEXT

B1P

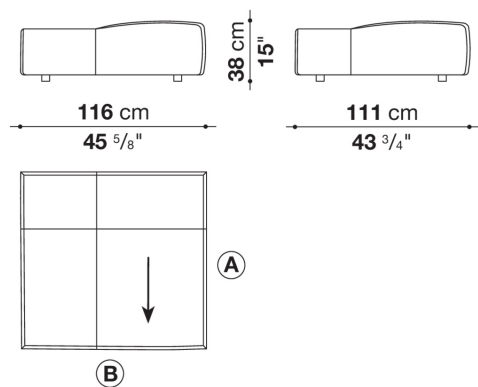

B2P

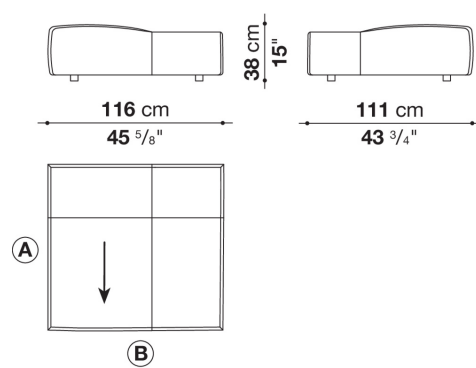

B3P

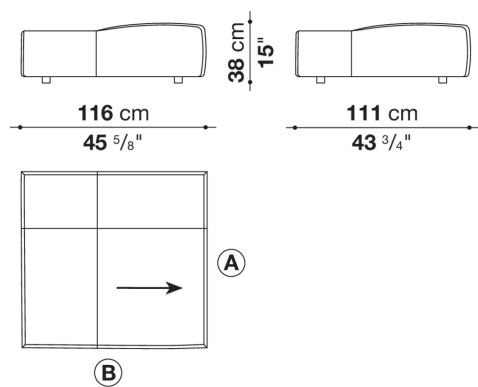

B4P

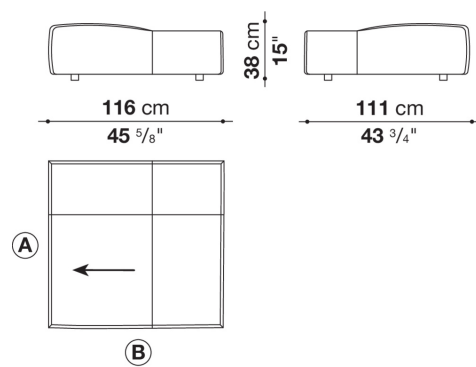

CONTEXT

ENQUIRIES
info@contextgallery.com

Tel. 404. 477. 3301
Tel. 800. 886.0867

contextgallery.com