

Flat.C

LIVING STORAGE UNITS

2008

Antonio Citterio

CONTEXT

ENQUIRIES
info@contextgallery.com

Tel. 404. 477.3301
Tel. 800. 886.0867

contextgallery.com



Description

Flat.C interprets the wall-system as an open system that can be reconfigured and reassembled. Advanced and flexible, Flat.C suggests a free way of occupying space, following the evolution of multimedia systems. The Flat.C storage units offer an intelligent use of space through an almost infinite number of different configurations based on a modular grid that organises the composition elements and restricts proportions. As we all have size constraints in our houses, we need furnishings that can store large amounts even in limited spaces. Flat.C was designed to house books, a television and hi-fi accessories in the smallest amount of space possible. As the name suggests, Flat.C is a solution offering shallow depths and thicknesses. Measuring only 25 cm in depth, the thickness of the shelves and sides has been reduced to the minimum. Moreover, there are no visibly joined parts. All this creates a versatile furnishing project that fits discreetly into the room, while elegantly fulfilling its storage purpose.

Technical information

Lateral sides, central sides, side end elements, central and upper crosspieces, baseboards, binary covers, cable flap duct, cable flap duct with light

aluminium extrusions

Tops, shaped tops, top end elements, partitions, backs, back end elements, covers for sliding door and cable flap duct, audio video storage unit, open projecting elements, projecting elements for flap door, projecting elements for drawer, extractable tray audio video element, multipurpose top

wood particles panel, MDF wood fibre panel

Back panels for TV/Home office

panel in cellulose fibre impregnated with thermosetting resins, subjected to high pressure processing

Glass top, glass top for cable flap duct, flap doors for audio video element

tempered glass

Sliding doors, flap door for projecting elements, drawer fronts for projecting elements

glass, wood particles panel, MDF wood fibre panel

Internal shelves for projecting elements with flap door, internal shelves for projecting elements with drawer

tempered glass

Cable flap

aluminium

CD/DVD frame

anodized aluminium extrusions

Frames

steel

LED lighting system

LED HE Strip light 12V DC 1.65W 5000K

EU power supply unit

input voltage 220-240V 50Hz, output voltage 12V DC, mMaximum wattage 30W

US power supply unit

input voltage 110-120V 50Hz, output voltage 12V DC, maximum wattage 30W

Touch-LED switch

operating voltage 12 V DC

CONTEXT

ENQUIRIES
info@contextgallery.com

Tel. 404. 477. 3301
Tel. 800. 886.0867

Technical drawings

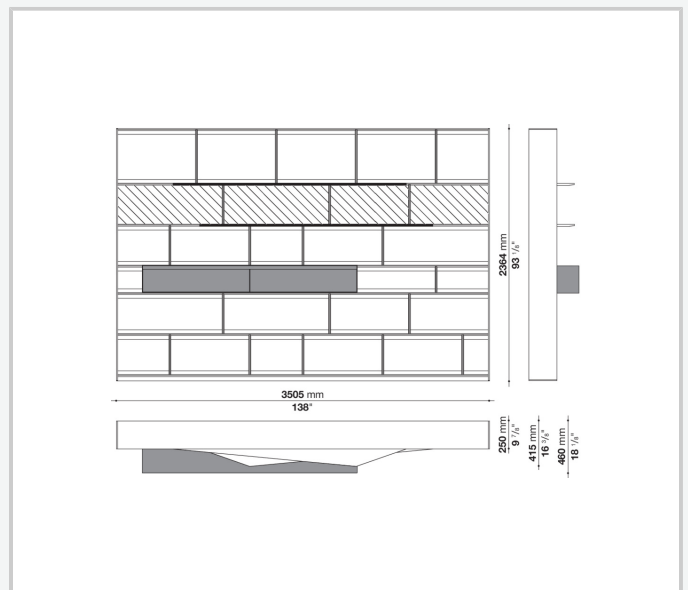
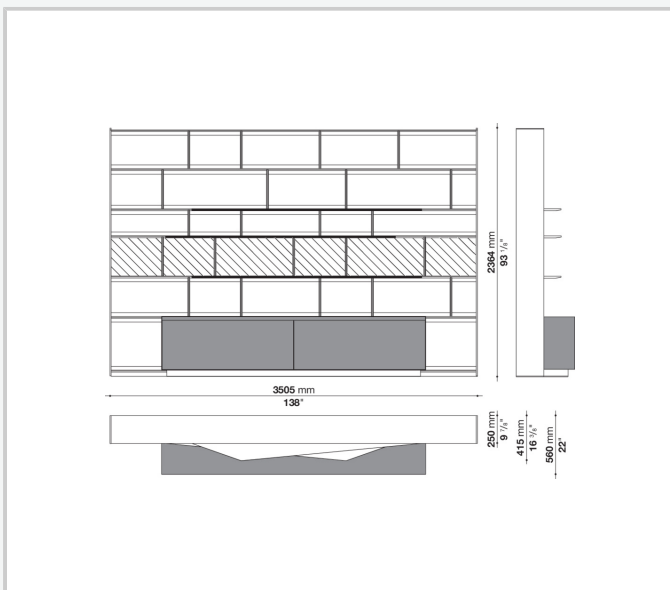
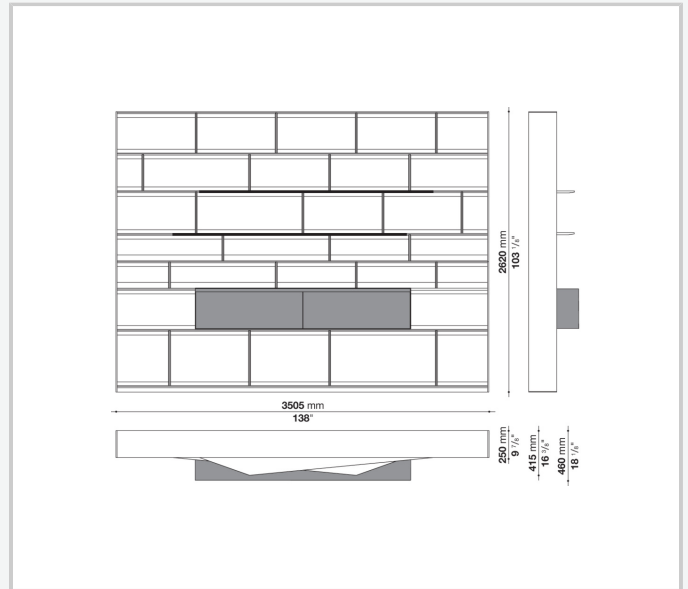
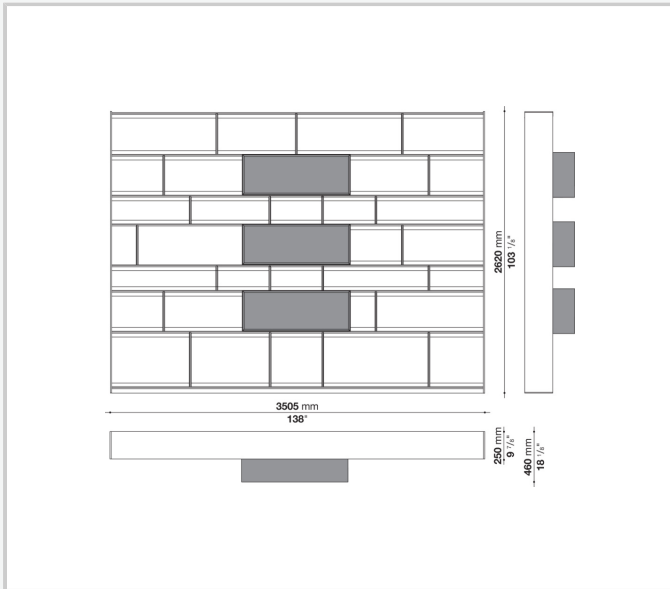
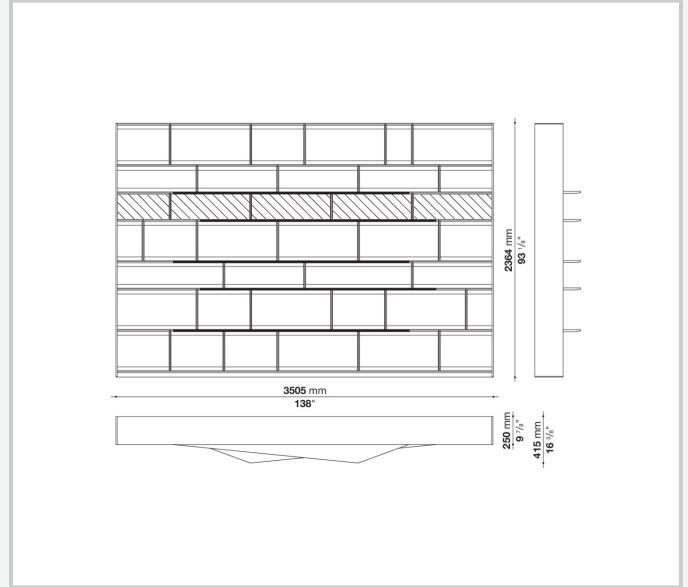
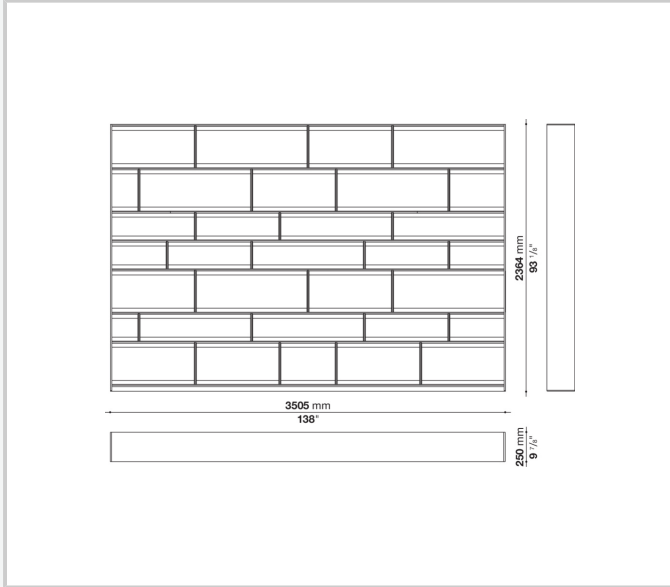

CONTEXT

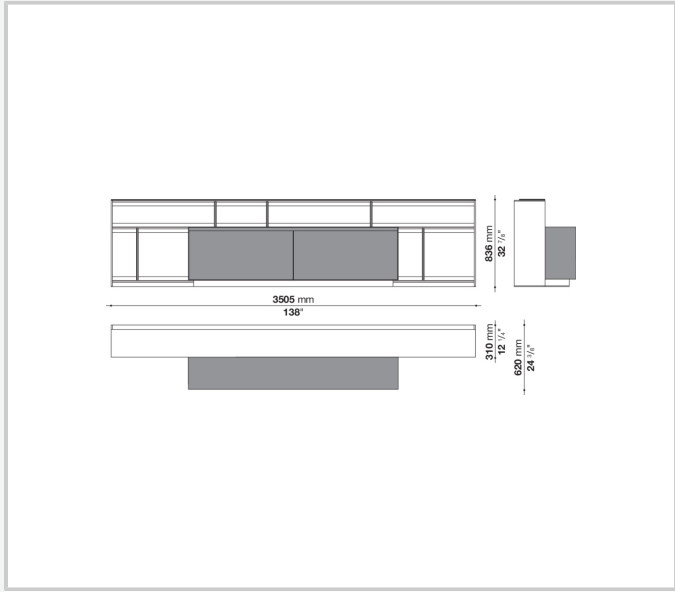
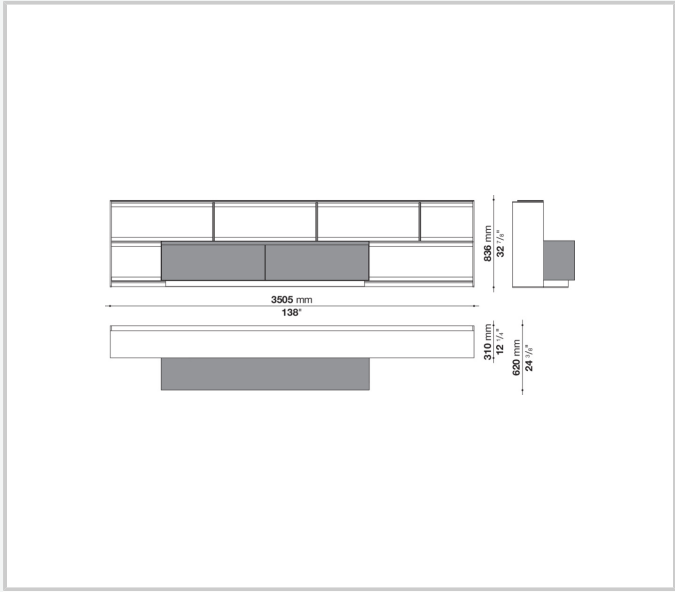
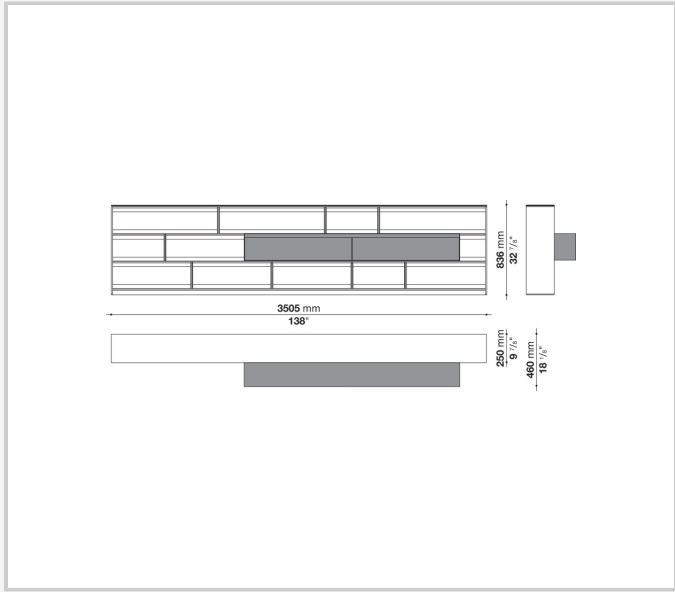
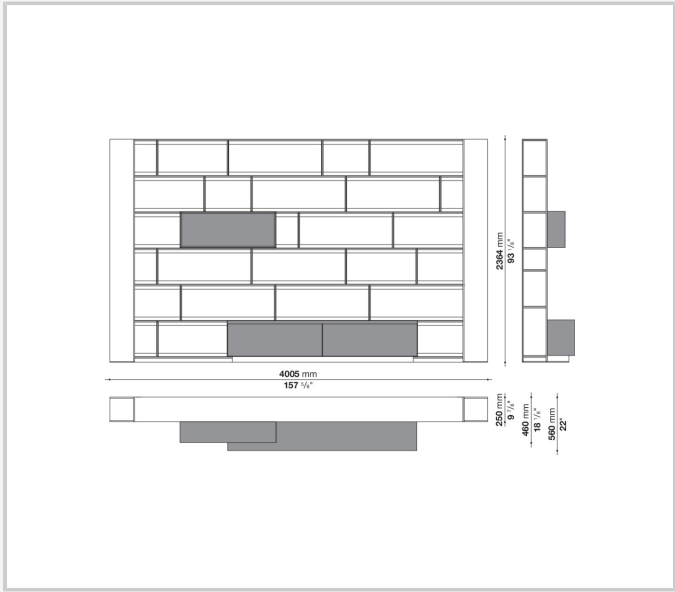
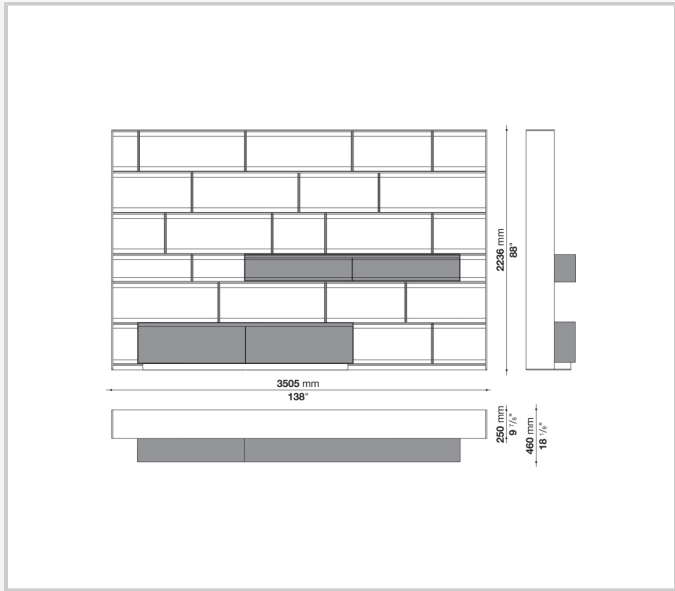
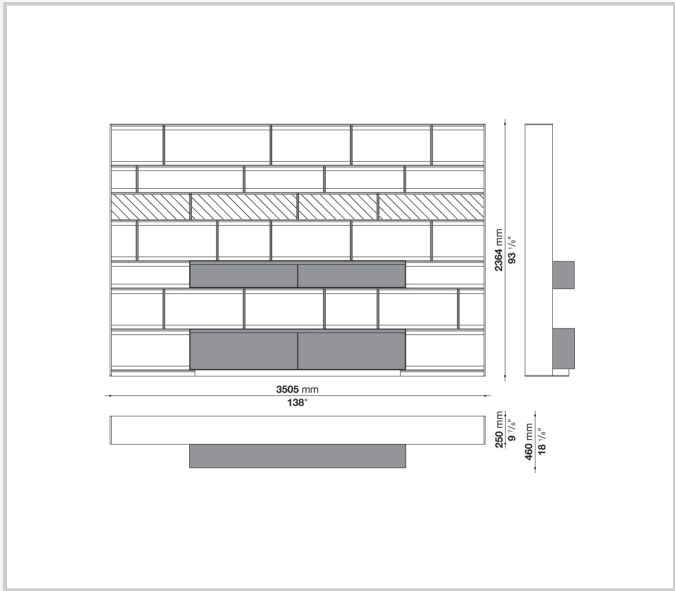

CONTEXT

ENQUIRIES
 info@contextgallery.com
 Tel. 404. 477. 3301
 Tel. 800. 886. 0867
 contextgallery.com

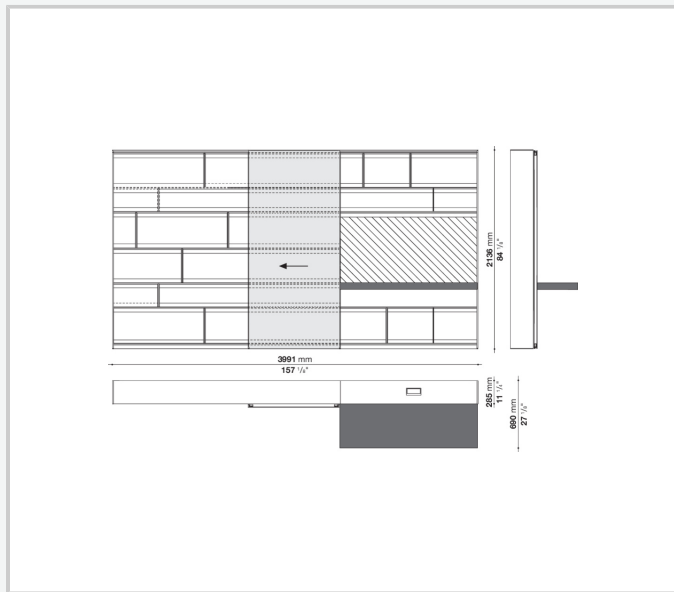
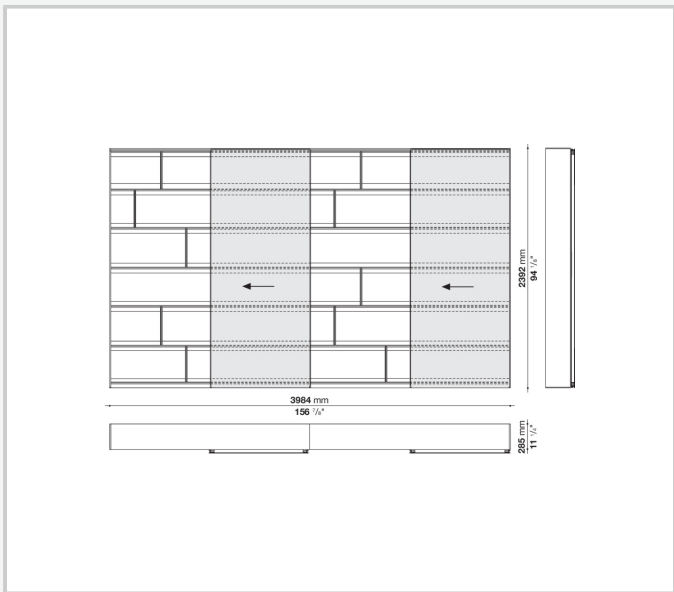
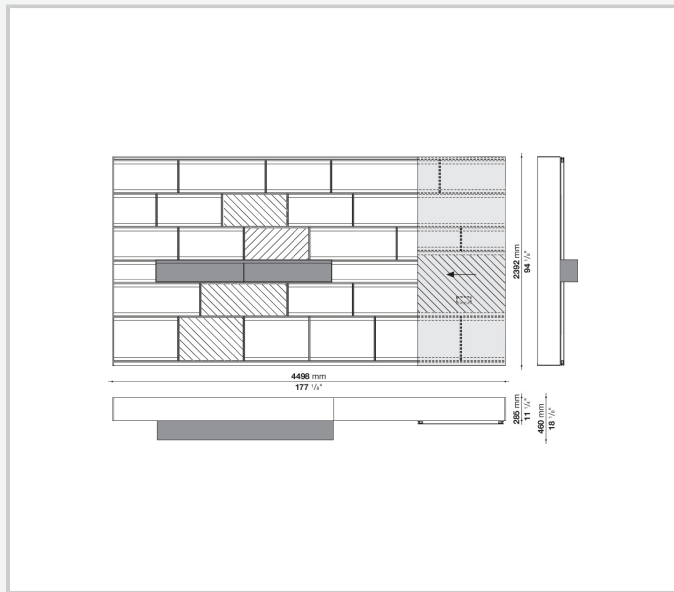
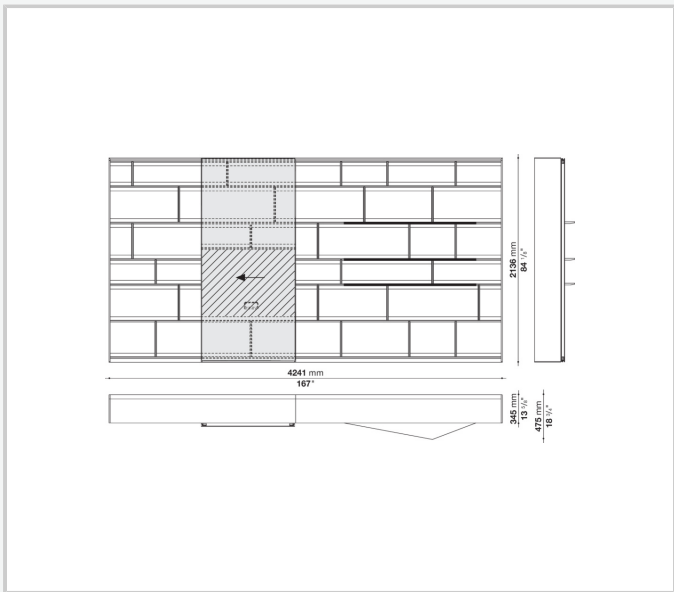
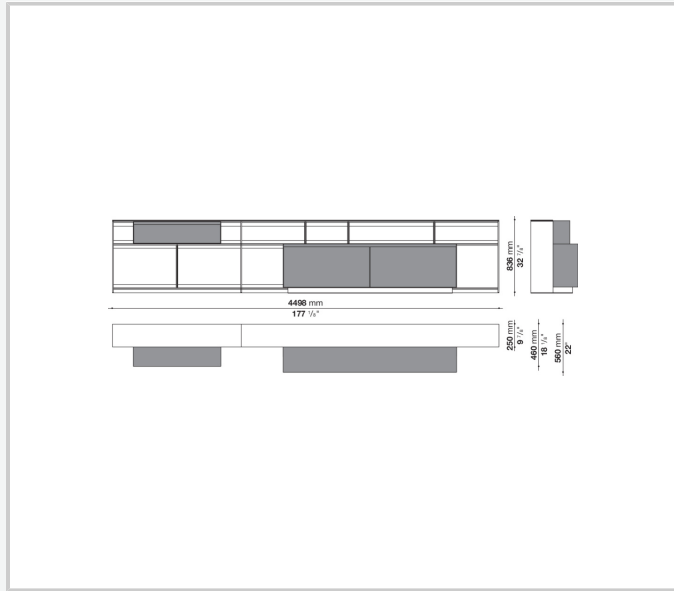
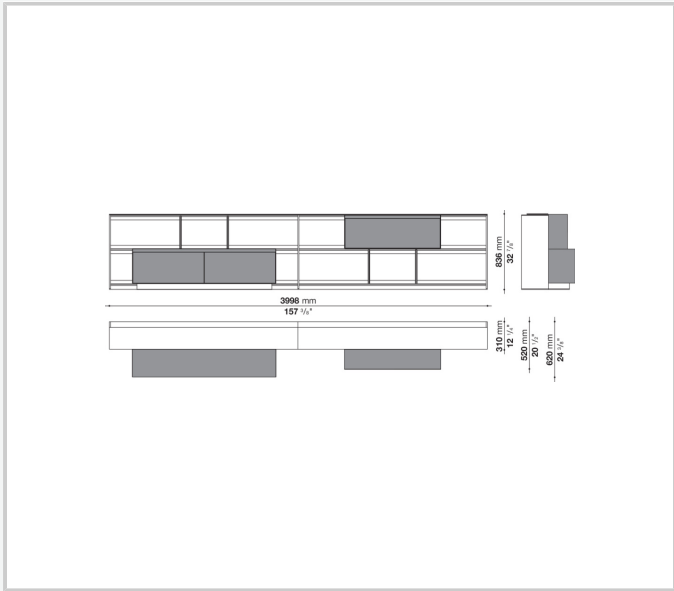

CONTEXT

ENQUIRIES
 info@contextgallery.com
 Tel. 404. 477. 3301
 Tel. 800. 886. 0867
 contextgallery.com

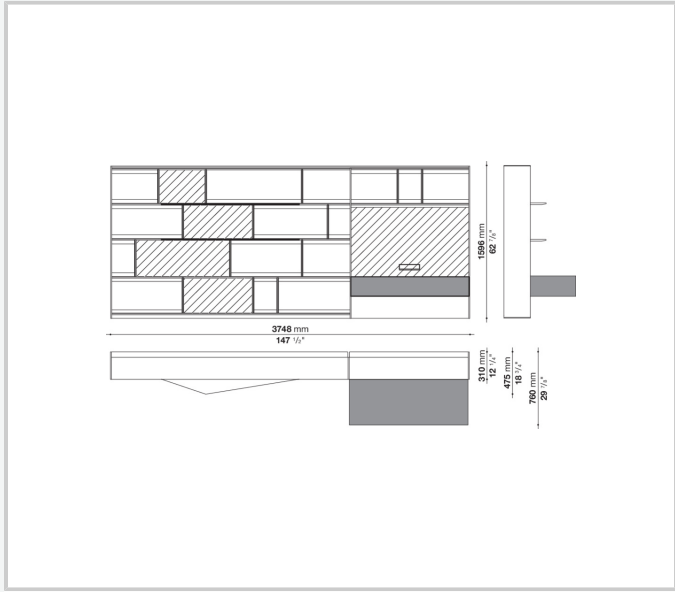
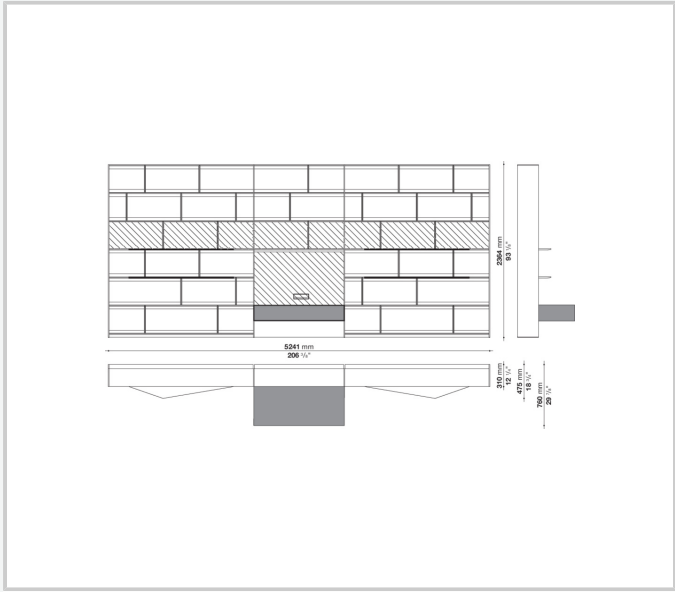
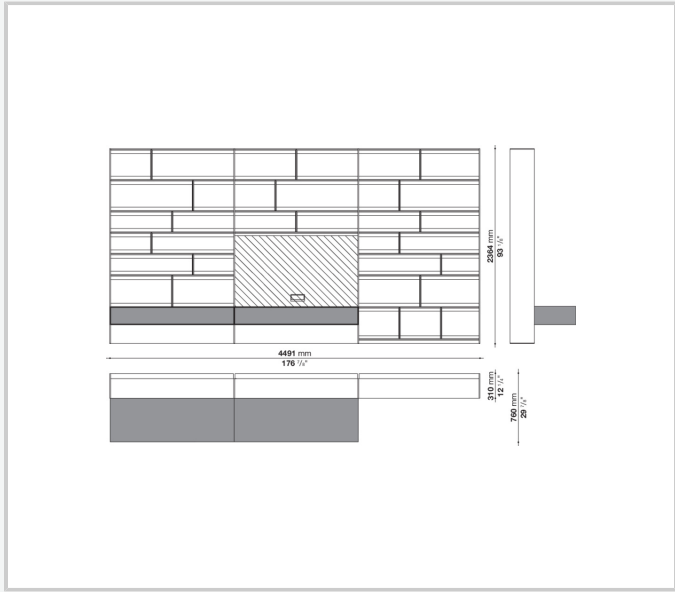
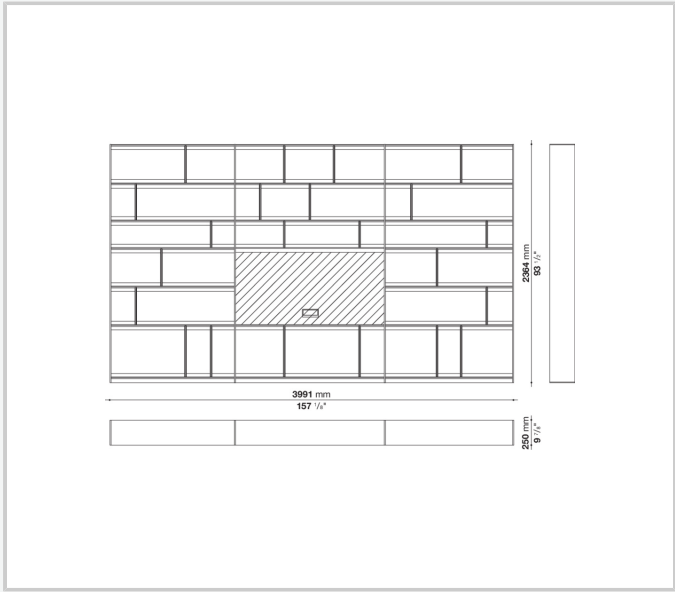
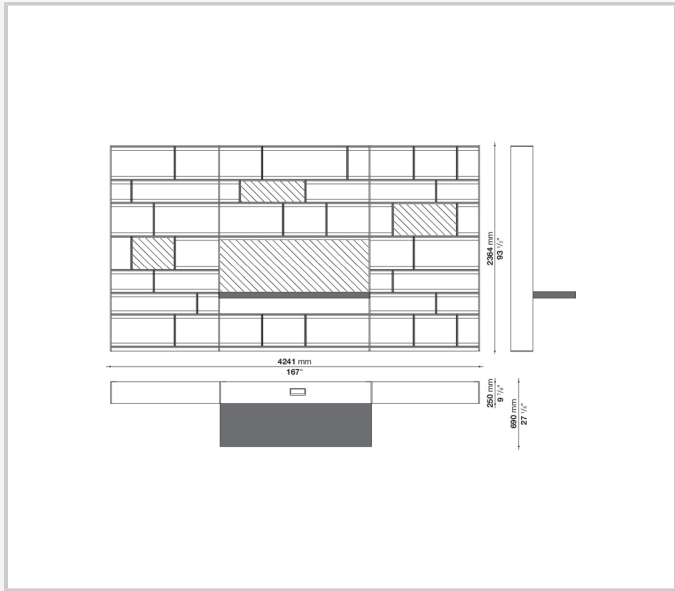
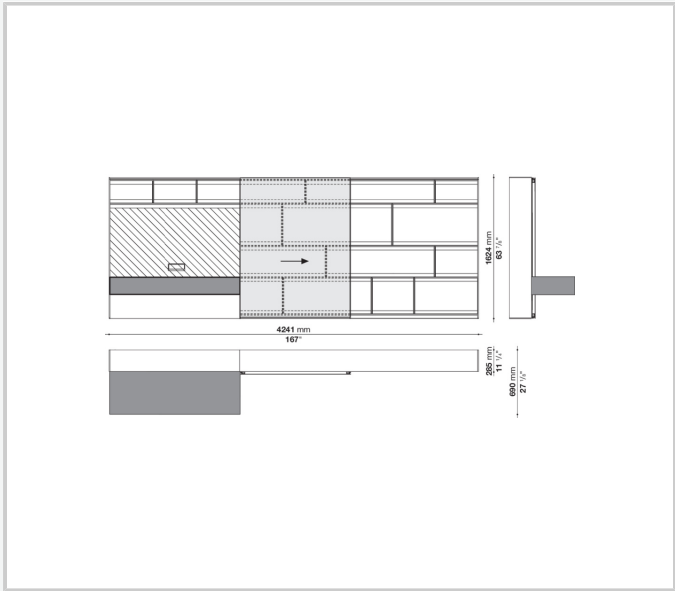

CONTEXT

ENQUIRIES
 info@contextgallery.com
 Tel. 404. 477. 3301
 Tel. 800. 886. 0867
 contextgallery.com

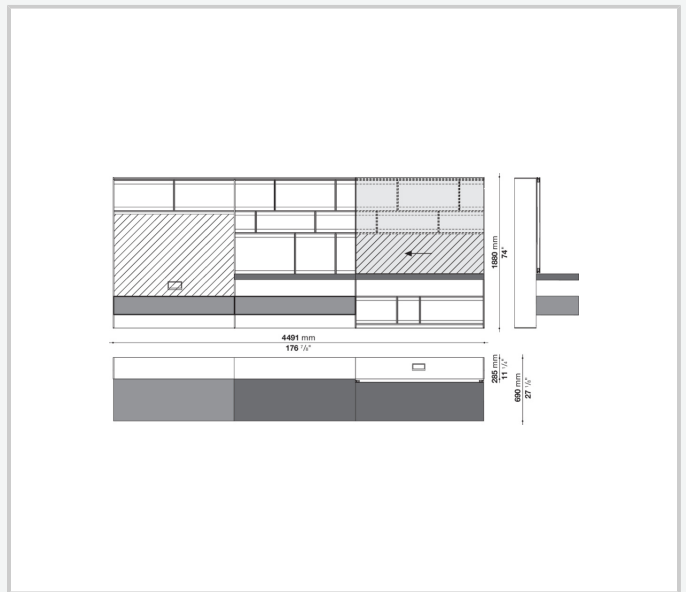
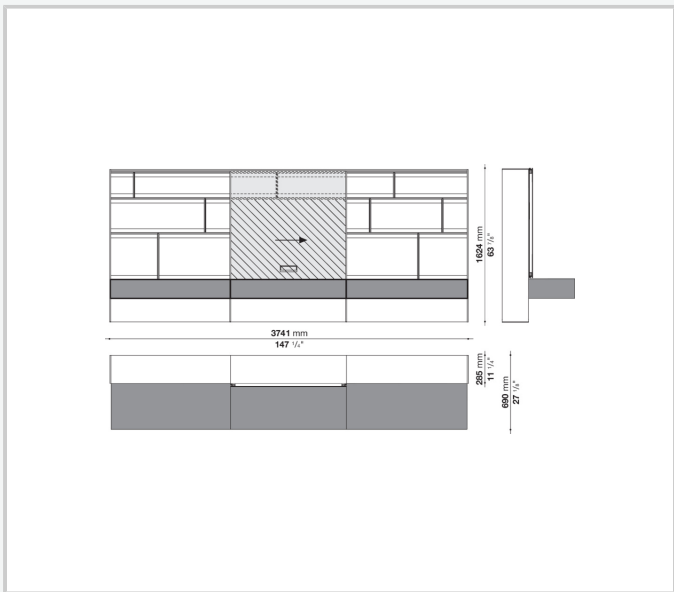
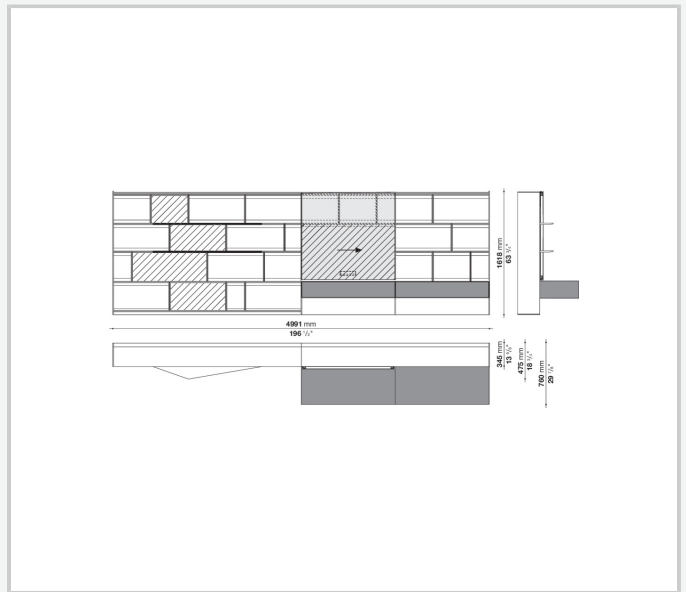
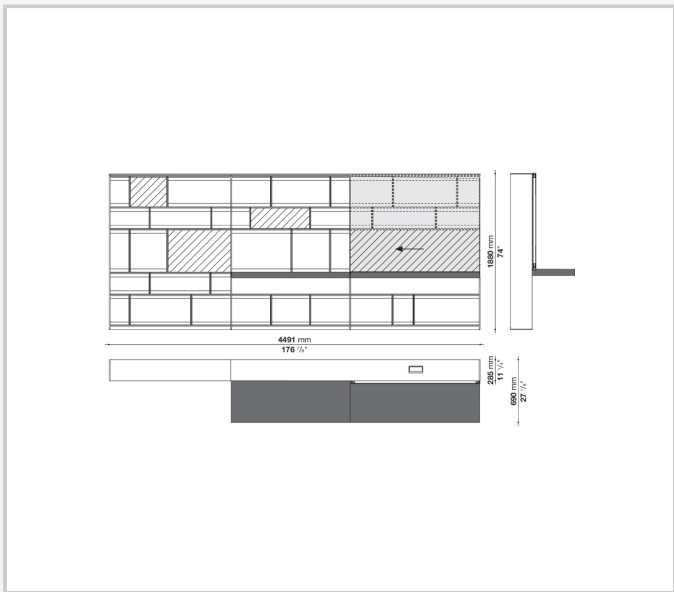
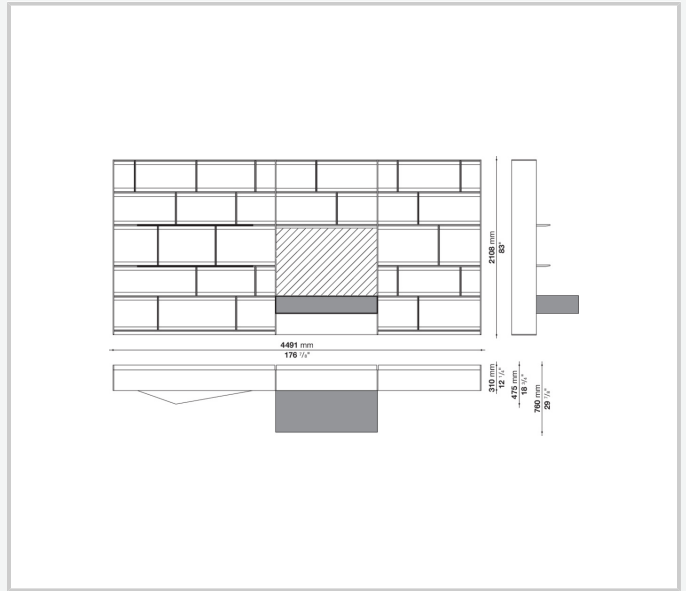
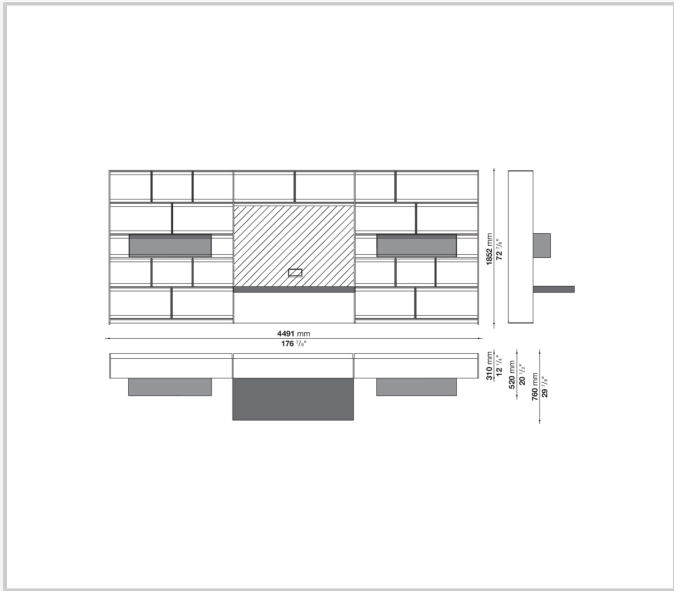

CONTEXT

ENQUIRIES
 info@contextgallery.com
 Tel. 404. 477. 3301
 Tel. 800. 886. 0867
 contextgallery.com

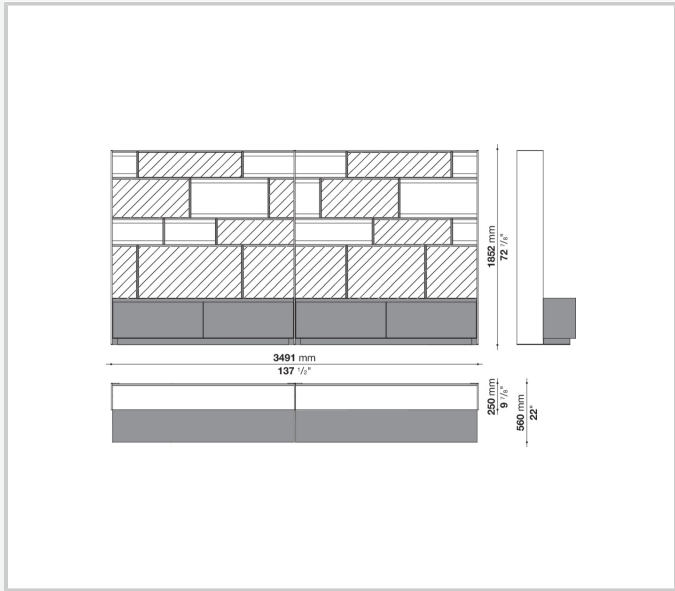
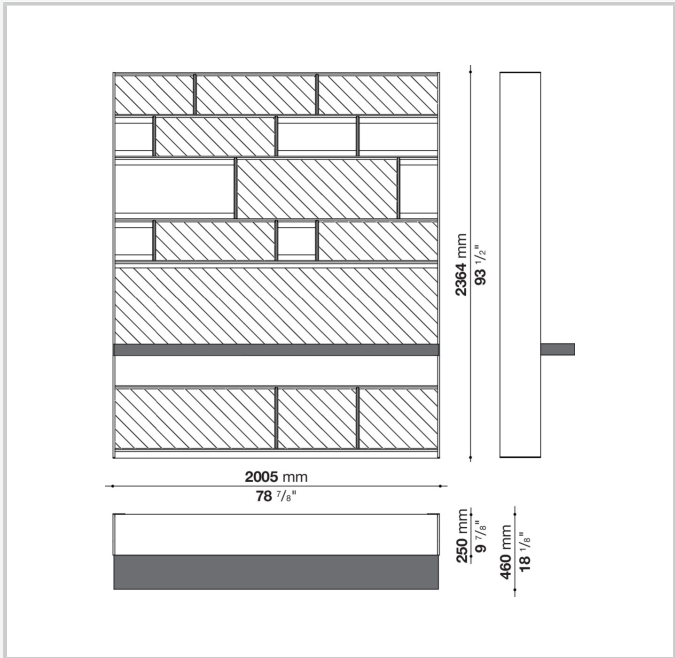

CONTEXT

ENQUIRIES
info@contextgallery.com

Tel. 404. 477. 3301
 Tel. 800. 886.0867