



## Havana

Designer: Lievore Altherr Molina  
Year: 2005

Havana is a synthesis of elegance and flexibility. From an elegant centrepiece of any space it can be transformed with a simple action into a bed with storage. Versatile also by virtue of the choice of a number removable covers and base options in aluminium or wengè finish.

Developed by Tacchini in Italy

## Dimensions (cm)

Cod. OHAV135

Cod. OHAV225

Cod. OHAV255

Cod. OHAVP100

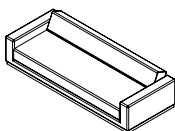
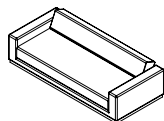
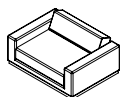

W 135 D 102 cm  
H 69 H seat 38 cm

W 225 D 102 cm  
H 69 H seat 38 cm

W 255 D 102 cm  
H 69 H seat 38 cm

W 100 D 60 cm  
H 38 H seat 38 cm

## Removable covers

CAD Files:  
3D (.dwg, .3ds)  
2D (.dwg)

Download CAD  
files at [tacchini.it/en/downloads](http://tacchini.it/en/downloads)

## CONTEXT

ENQUIRIES  
[info@contextgallery.com](mailto:info@contextgallery.com)

Tel. 404. 477. 3301  
Tel. 800. 886.0867

[contextgallery.com](http://contextgallery.com)  
[contextcontract.com](http://contextcontract.com)

### Materials description

Internal frame: fir wood 30 mm thick with metal frame with elastic belts.

Padding: differentiated - density polyurethane foam.

Base: MDF laminate plated, available in Aluminium, Gloss Aluminium or Wengè.

Upholstery: fully removable cover.

## Base

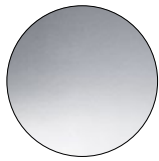

Aluminium



Gloss aluminium

T50  
Wengè

## Materials informations

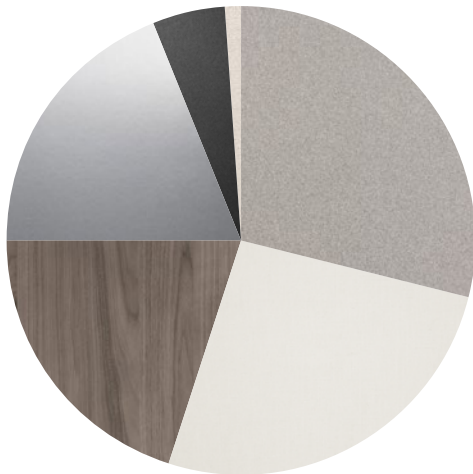

Polyurethane foam	29%
Upholstery	26%
Fir wood	20%
Iron components	19%
Elastic belts	5%
MDF	1%

## Polyurethane

Flexible expanded polyurethane is a solid elastic polymeric material with open cell structure. It is a non-toxic material and above all free from ozone-damaging components. Production and processing of the polyurethane we use meet the objectives of the new policy of ensuring the protection of human health and of the environment. We focus in particular on the choice and use of the types of density of polyurethane suitable for preserving over the years the features of load capacity, elasticity and resilience. For products used in public spaces flame-retardant expanded polyurethane is chosen, tested and certified according to international regulations.

## Elastic belts

The elastic belt used on the seats of our upholstered products is a component to be chosen with care in order to ensure adequate elasticity and springing for the dimension and the structure of the product. We use plaited elastic webbing to add greater comfort and resistance to weight stresses.

## Metal

The need to combine complex yet lightweight shapes with resistant materials necessarily involves the use of metals such as steel and aluminium. Products in polyurethane foam are made with an inner steel frame for adding strength to the structure. The bases are in tubular metal which can be chromed with a gloss or satin finish or painted with epoxy powders.

## Wood

Wood is a renewable raw material. All products derived from wood, such as for example plywood, have the advantage of being able to be machined more easily than wood and do not deform. The timber we use – solid or plywood – comes mainly from European and Russian forests and is seasoned to specific values of humidity with tests. Most of the structures of the products in the collection have a frame in solid pine or ash, or in beech or poplar plywood.

## Recyclability

All Havana elements are 100% recyclable when fully separated. Tacchini undertakes on-going research and development, with efforts made to introduce products which are a perfect combination of function and safety without jeopardizing the final design of the same articles. During production attempts are made to minimize noise and emission levels and to reduce rejects as far as possible. All the single materials which make up the production process, once disassembled, can be reused several times, maintaining a high quality standard.

## Packaging

Havana element is dispatched already assembled. It is protected by tissue paper and cellophane to protect the covering from dust and direct contact with the cardboard. The product is packed in rigid cardboard boxes suitable for world export. Manufacture of the packaging observes the criteria for recovery both as recycling and energy recovery and composting.

Once a product reaches the end of its life cycle it has to be eliminated.

To discover more about Tacchini environmental policy please visit: [www.tacchini.it](http://www.tacchini.it)